

HP254 GT

Pitch:	25.4 mm
Belt Surface:	Close, Friction Surface
Minimum Width:	152.4 mm
Open Area (%):	%0
Flight:	Yes (T25, T50, TC50, T75)
Sidewall:	Yes (h=25 mm, h=50 mm)
Rod:	Ø4.9 mm
Approved:	FDA and EU
Curve:	No
Color:	Additional colors available
Cleanability:	Good
Belt Width:	13 mm

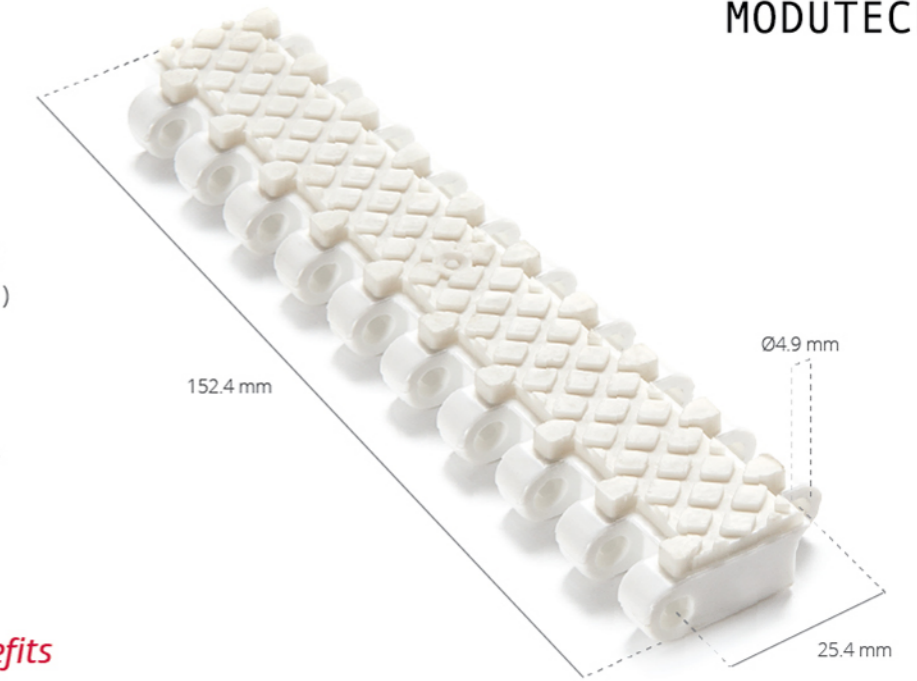

Product Features and Functional Benefits

- Unique rubber top eliminates wear and increases friction in incline decline applications.
- Unique sprocket engagement - higher product load and longer conveyors.
- Unique sprocket engagement reduces pulsation and increases load capacity.
- Close transfer applications.
- High power, bi-directional belt for long conveyors.

HP254 GT / Technical Information

BELT MATERIAL	BELT STRENGTH				TEMPERATURE		BELT WEIGHT Kg/m ²
	Straight		Curve		C(min.)	C(max.)	
	Kg/m	N/m	Kg/m	N/m			
Polypropylene	1462	14620	-	-	+5	+90	7.30
Polyethylene	1300	13000	-	-	-73	+66	7.60
Acetal	-	-	-	-	-	-	-

- Belt strength and temperature values are maximum on the table.

HP254 GT / Standard Belt Widths

BELT SERIES	WIDTH (W)				Belt Width Tolerance (max.)
	PP-PE		POM		
	(mm)	(inch)	(mm)	(inch)	
HP254	152,4	6"	152,4	6"	± 0,5 mm
HP254	228,6	9"	228,6	9"	± 2 mm
HP254	304,8	12"	304,8	12"	± 2 mm
HP254	381	15"	381	15"	± 3 mm
HP254	457,2	18"	457,2	18"	± 3 mm
HP254	533,4	21"	533,4	21"	± 3 mm
HP254	609,6	24"	609,6	24"	± 3 mm
HP254	685,8	27"	685,8	27"	± 4 mm
HP254	762	30"	762	30"	± 4 mm
HP254	838,2	33"	838,2	33"	± 4 mm
HP254	914,4	36"	914,4	36"	± 4 mm
HP254	990,6	39"	990,6	39"	± 4 mm
HP254	1066,8	42"	1066,8	42"	± 4 mm
HP254	1143	45"	1143	45"	± 4 mm

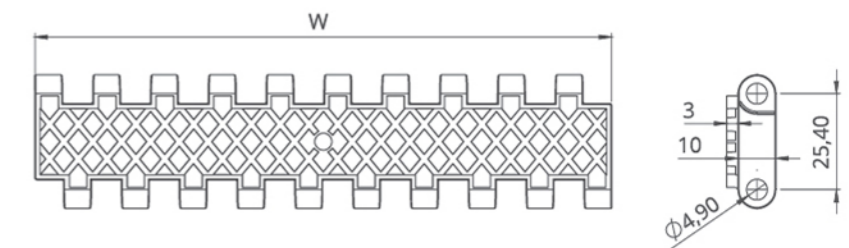

- Standard belt increments 76.2 mm.
- Non standard belt increments 15 mm.
- Please contact with customer service for precise belt measurements.

HP254 GT

Modular Belt Series

• Snack Food Applications

Incline - Decline Lines, Container Conveyance

• Tire Manufacturing Applications

Batch Off Incline, Calendering Infeed, Extrusion Infeed, Tire Transport

Incline - Decline Lines

• Packaging Applications

Box Incline - Decline Lines

HP254 Series Sprockets and Technical Specifications

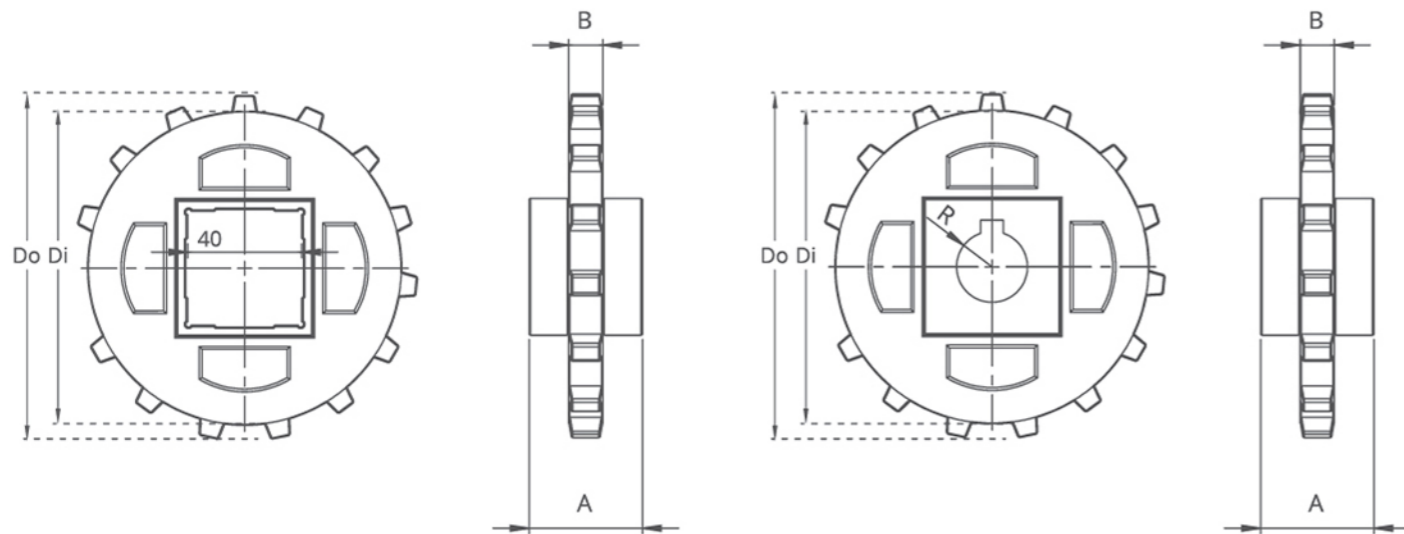

HP254 Series / Standard Sprockets Dimensions

NO.TEETH	Di	Do	B	A	Square Bore (Q)	Round Bore (R)	PRODUCT CODE	
							Square Type (Q)	Round Type (R)
Z10	71.6 mm	82.5 mm	12.0 mm	40.0 mm	40.0 mm	25.0 / 30.0	HP254SQZ10*POM	HP254SRZ10*POM
Z12	89.0 mm	99.5 mm	12.0 mm	40.0 mm	40.0 mm	25.0 / 30.0	HP254SQZ12*POM	HP254SRZ12*POM
Z15	114.0 mm	124.0 mm	12.0 mm	40.0 mm	40.0 mm	25.0 / 30.0	HP254SQZ15*POM	HP254SRZ15*POM
Z18	138.3 mm	149.5 mm	12.0 mm	40.0 mm	40.0 mm	25.0 / 30.0	HP254SQZ18*POM	HP254SRZ18*POM

*Other sprockets and hub sizes are manufactured up to request. *POM (Acetal) and PP (Polypropylene) sprockets raw material is available on request.

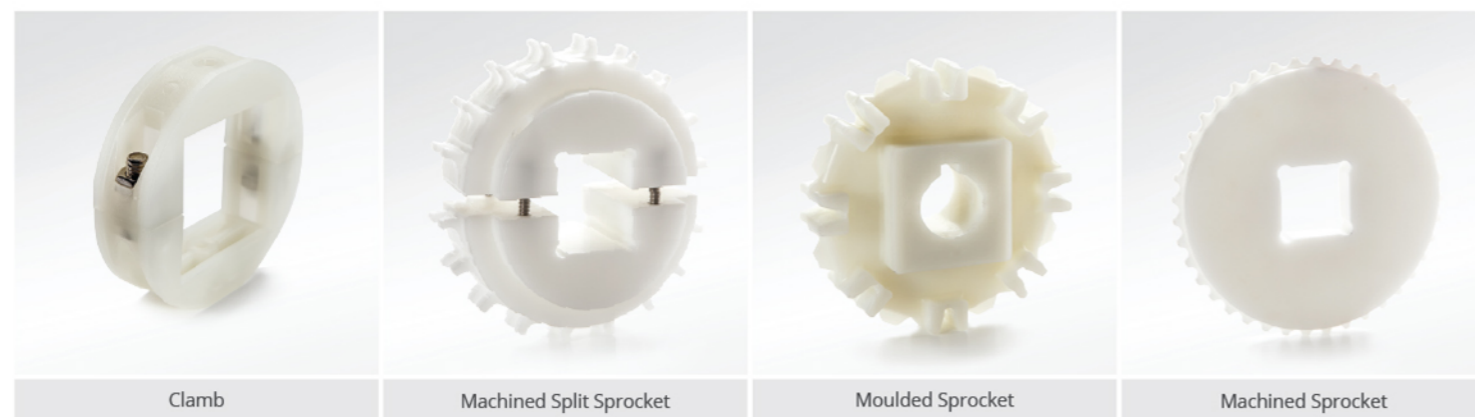

HP254 Series Accessories and Technical Specifications

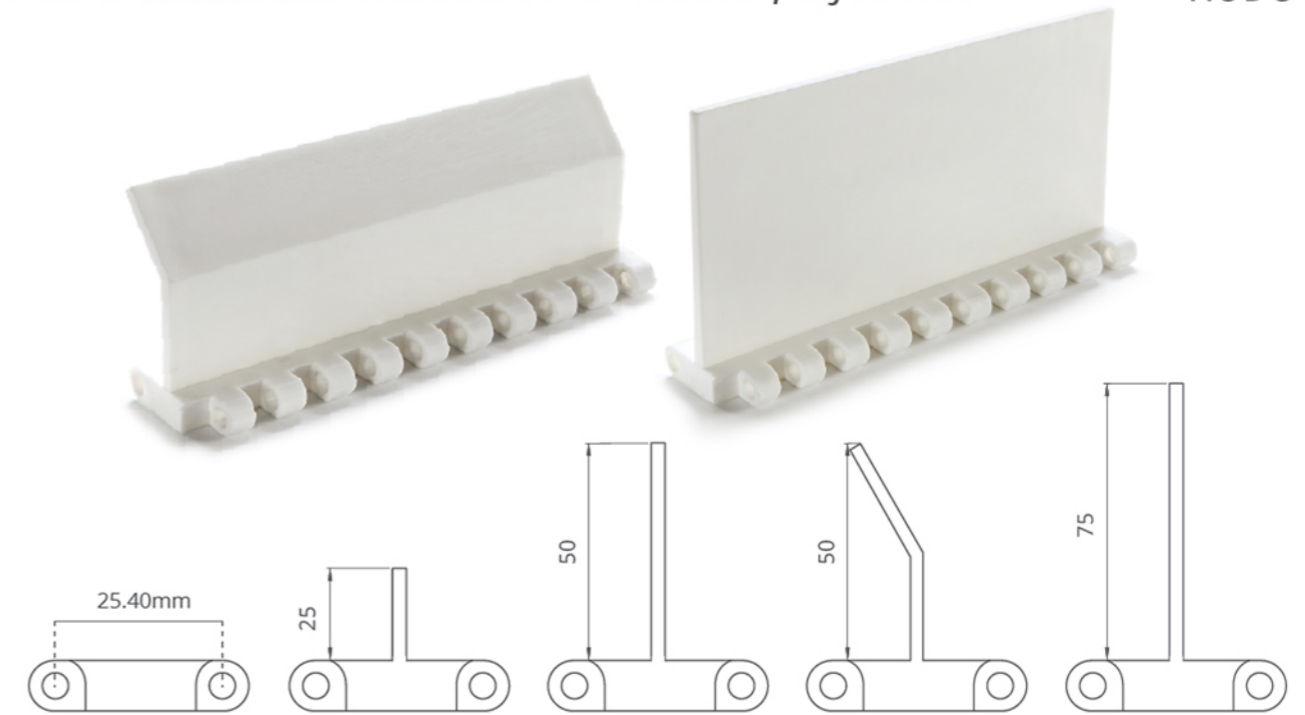

* Additional flight dimensions are available up to 75 mm

HP254 Series / Flight Technical Specifications

Possible Flight Indets for 25,4 mm Series	Z	
	(mm)	(inch)
Standart, no module cutting	15	0,59
Standart, no module cutting	30	1,18
Standart, no module cutting	45	1,77
Standart, no module cutting	60	2,36
Standart, no module cutting	75	2,95

*Non-standard flight indent is on request.

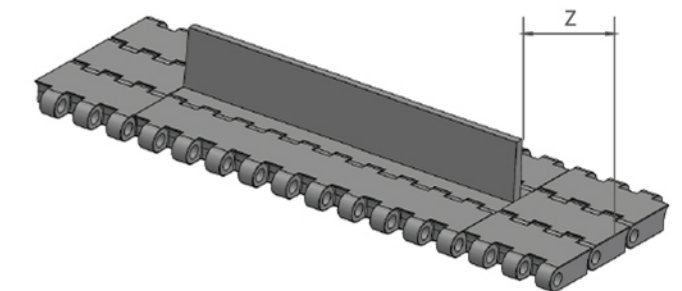

HP254 Series / Comb Technical Specifications

	(inch)	(mm)
A	4,1-4,5	105-115
B	0,98	25
C	0,49	12,5
D	5,75	146
E	5,91	150
F	2,95	75
G	1,48	37,5
X	6,10	155

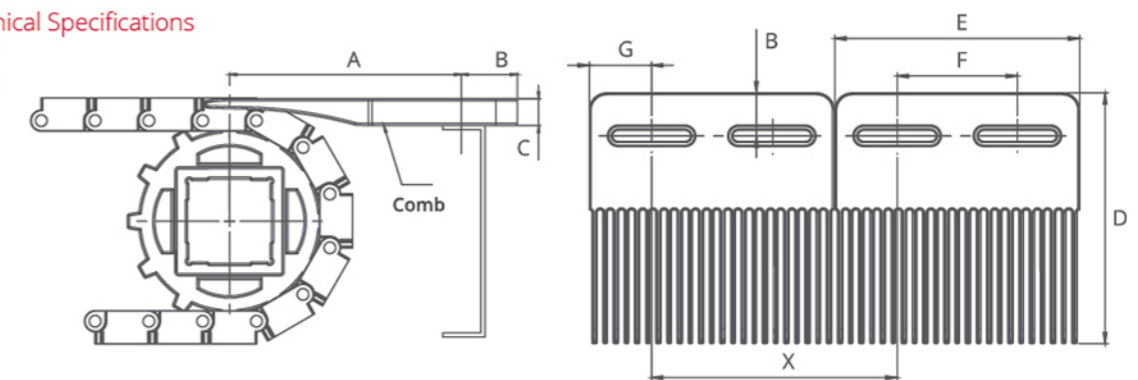

HP254 Series / Sidewall Technical Specifications

Possible Sidewall and Flight Indets	X		Y	
	(mm)	(inch)	(mm)	(inch)
Standart, no module cutting	24	0,94	15	0,59
Module cutting necessary	32	1,26	22	0,87
Standart, no module cutting	40	1,57	30	1,18
Module cutting necessary	48	1,89	37	1,46
Standart, no module cutting	56	2,20	45	1,77
Module cutting necessary	64	2,52	53	2,09

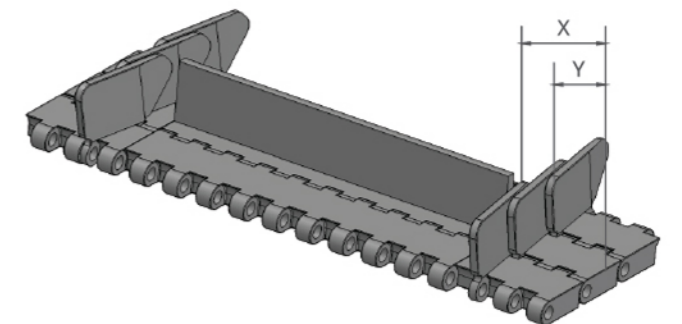

Note: Gap between flight and sidewall minimum 2-3 mm
Gap between flight and sidewall maximum 10 mm

HP254 Series Engineering Information

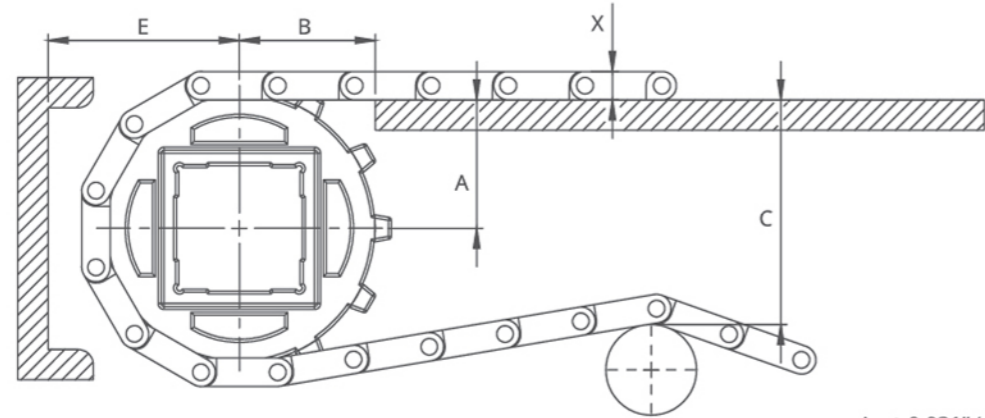

A - ± 0,031" (1mm) C - ± (Max.)
 B - ± 0,125" (3mm) E - ± (Min.)

HP254 Series / Conveyor Frame Dimensions

Sprockets Description			A		B		C		E		X	
Pitch Diameter		No.Teeth	Range (Bottom to Top)		In.	mm	In.	mm	In.	mm	In.	mm
In.	mm		In.	mm								
HP254 C, HP254 PR%23												
3,07	78	10	1,45	36,75	1,65	42	2,36	60	2,23	56,75	0,39	10
3,70	94	12	1,79	45,5	1,77	45	2,95	75	2,58	65,5	0,39	10
4,61	117	15	2,15	54,5	2,01	51	3,35	85	2,93	74,5	0,39	10
5,59	142	18	2,76	70	2,17	55	4,33	110	3,54	90	0,39	10
HP 254 GT												
3,07	78	10	1,45	36,75	1,65	42	2,48	63	2,35	59,75	0,51	13
3,70	94	12	1,79	45,5	1,77	45	3,07	78	2,70	68,5	0,51	13
4,61	117	15	2,15	54,5	2,01	51	3,46	88	3,05	77,5	0,51	13
5,59	142	18	2,76	70	2,17	55	4,45	113	3,66	93	0,51	13
HP 254 RR												
3,07	78	10	1,45	36,75	1,65	42	2,59	65,7	2,46	62,45	0,62	15,70
3,70	94	12	1,79	45,5	1,77	45	3,18	80,7	2,80	71,2	0,62	15,70
4,61	117	15	2,15	54,5	2,01	51	3,57	90,7	3,16	80,2	0,62	15,70
5,59	142	18	2,76	70	2,17	55	4,56	115,7	3,77	95,7	0,62	15,70

HP254 Series / Slider Support System For Straight Running Belts

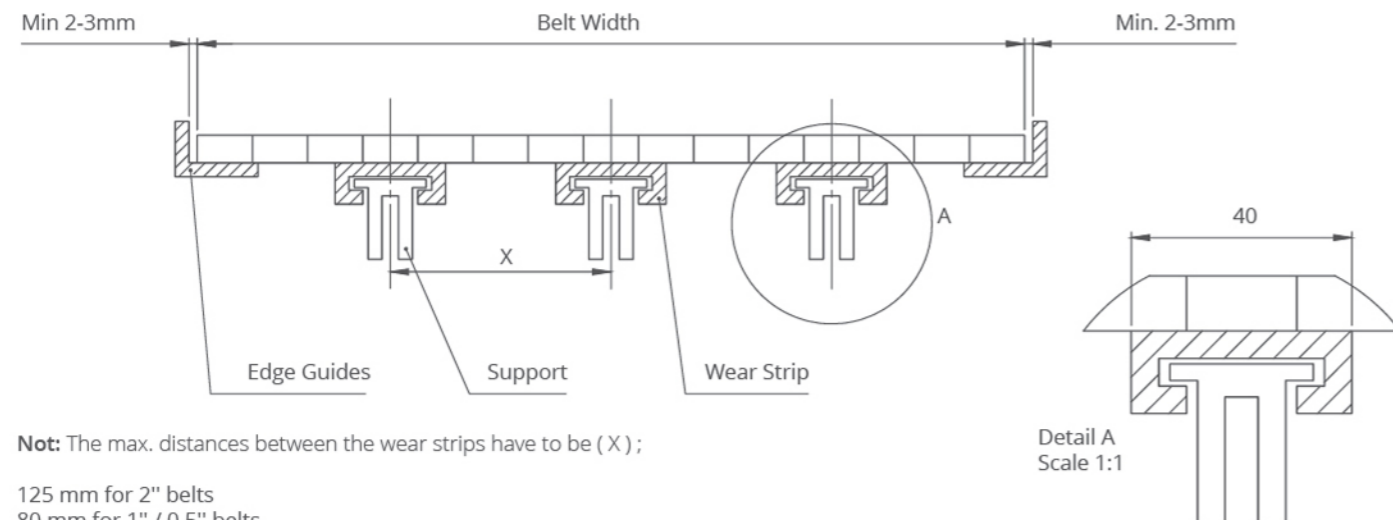

Not: The max. distances between the wear strips have to be (X) ;

125 mm for 2" belts
 80 mm for 1" / 0.5" belts

HP254 Series Engineering Information

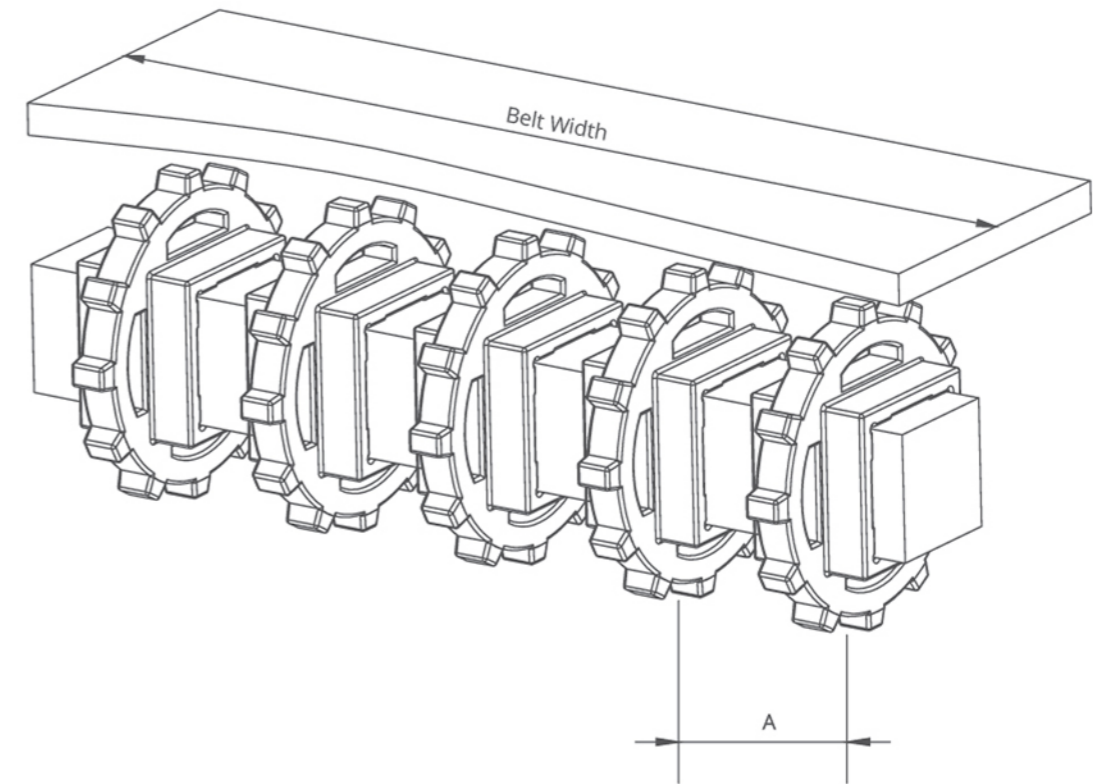

HP254 Series / Sprockets Arrangement

Standard Belt Width		Number of sprockets per shaft		A (mm/inch)	
mm	inch	Drive Shaft	Return Shaft	Min.	Max.
152,4	6	2	2	60/2,36	170/6,6
228,6	9	2	2	60/2,36	170/6,6
304,8	12	3	2	60/2,36	170/6,6
381	15	4	3	60/2,36	170/6,6
457,2	18	5	3	60/2,36	170/6,6
533,4	21	5	3	60/2,36	170/6,6
609,6	24	6	3	60/2,36	170/6,6
685,8	27	6	4	60/2,36	170/6,6
762	30	7	4	60/2,36	170/6,6
838,2	33	7	4	60/2,36	170/6,6
914,4	36	8	4	60/2,36	170/6,6
990,6	39	8	5	60/2,36	170/6,6
1066,8	42	9	5	60/2,36	170/6,6
1143	45	9	5	60/2,36	170/6,6
1219,2	48	10	5	60/2,36	170/6,6
1295,4	51	10	6	60/2,36	170/6,6
1371,6	54	11	7	60/2,36	170/6,6
1447,8	57	11	7	60/2,36	170/6,6
1524	60	12	7	60/2,36	170/6,6
1600,2	63	12	8	60/2,36	170/6,6
1676,4	66	12	8	60/2,36	170/6,6
1752,6	69	13	8	60/2,36	170/6,6
1828,8	72	14	9	60/2,36	170/6,6
1905	75	14	9	60/2,36	170/6,6
1981,2	78	15	10	60/2,36	170/6,6
2057,4	81	15	10	60/2,36	170/6,6

Note: Number of sprockets depends on the belt load.